

BAKER TRUST
 C/O MYONA G BAKER POSR
 18730 BEAVER ST W
 JACKSONVILLE, FL 32234-1694

Primary Site Address
 18730 W BEAVER ST
 Jacksonville FL 32234

Official Record Book/Page
 09992-1004

Title #
 3428

Extra Features

LN	Feature Code	Feature Description	Bldg.	Length	Width	Total Units	Value
1	FPMA	Fireplace Masonry H	1	0	0	1.00	\$595.00

Land & Legal

Land										Legal	
LN	Code	Use Description	Zoning	Front	Depth	Category	Land Units	Land Value	LN	Legal Description	
1	9921	1-5 ACRES/SFR IMPS	AGR	0.00	0.00	Common	2.01	\$50,250.00	1	28-2S-23E 2.0	
									2	W1/2 OF NE1/4 OF NW1/4 RECD	
									3	O/R 9992-1004	

Buildings

Building 1
 Building 1 Site Address
 18730 W BEAVER ST Jacksonville FL 32234

Building Type	0101 - SFR 1 STORY SOH	
Year Built	1966	
Type	Gross Area	Heated Area
Base Area	1488	1488
Finished Open Porch	15	0
Addition	95	95
Unfin Det Garage	480	0
Total	2078	1583

Element	Code	Detail
Exterior Wall	19	Common Brick
Roofing Structure	3	Gable or Hip
Roofing Cover	3	Asph/Comp Shingle
Interior Wall	5	Drywall
Int Flooring	14	Carpet
Int Flooring	8	Sheet Vinyl
Heating Fuel	4	Electric
Heating Type	4	Forced-Ducted
Air Conditioning	3	Central

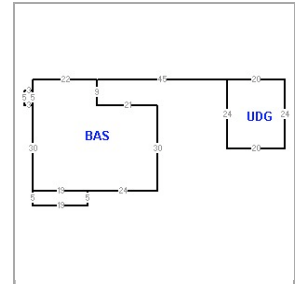

Element	Code	
Stories	1.000	
Bedrooms	3.000	
Baths	2.000	
Rooms / Units	1.000	

Traversing Data

Notice of Proposed Property Taxes (Truth in Millage Notice)

Taxing District	Base	Add'l Exemptions	Taxable Value	Last Year	Proposed	Rolled-back
General Gov Voted	\$36,758.00	\$0.00	\$36,758.00	\$0.00	\$0.00	\$0.00
Public Schools: By State Law	\$36,758.00	\$0.00	\$36,758.00	\$174.09	\$179.34	\$164.31
By Local Board	\$36,758.00	\$0.00	\$36,758.00	\$97.26	\$100.17	\$91.80
School Board Voted	\$36,758.00	\$0.00	\$36,758.00	\$12.05	\$5.55	\$5.55
General Gov. Ex B&B	\$36,758.00	\$0.00	\$36,758.00	\$339.71	\$311.86	\$321.50
Water Mgmt Dist. SJRWMD	\$36,758.00	\$0.00	\$36,758.00	\$16.28	\$15.28	\$15.75
FL Inland Navigation Dist	\$36,758.00	\$0.00	\$36,758.00	\$1.36	\$1.27	\$1.28
			Totals	\$640.75	\$613.47	\$600.19

	Just Value	Assessed Value	Exemptions	Taxable Value
Last Year	\$101,123.00	\$60,740.00	\$25,500.00	\$35,240.00
Current Year	\$150,581.00	\$62,258.00	\$25,500.00	\$36,758.00

Property Record Card (PRC)

The Property Appraiser Office provides available historical record cards (PRC). You must set your browser's Page Set Up for printing to Landscape to print these cards.

- [2005](#)
- [2004](#)
- [2003](#)
- [2002](#)
- [2001](#)
- [2000](#)
- [1999](#)
- [1998](#)

1997

More Information

Parcel Tax Record (http://www.governmax.com/collectmax/site_authlink.asp?agencyid=fl-duval-taxcollector&a=0009470010)

GIS Map (<http://maps.coj.net/MapIt.asp?ReNum=000947+0010>)

Map this property on Google Maps (<http://maps.google.com/maps?q=18730+W+BEAVER+ST,+Jacksonville+FL+32234>)